

Wilhem Willink & o^{rs}

No 2496

W^m Willink & o^{rs}

No 2492

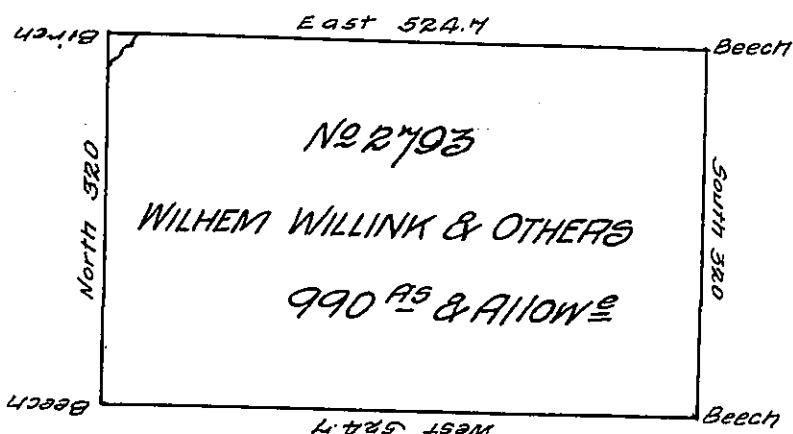

No 2666

W^m Willink & o^{rs}

No 2791

W^m Willink & o^{rs}

A Draught of a tract of land Situate near the head of the North East branch of big Toby's Creek Surveyed the tenth day of July 1793 In pursuance of a Warrant No 2793 to Wilhem Willink, Nicholaas Van Staporst, Christiaan Van Eghen, Hendrik Vollenhoven, and Rutger Jan Schimmelpenninck of Amsterdam Dated the thirteenth day of December 1792 for 900 Acres Containing Nine Hundred & Ninety As & the Usual Allowance of Six pr Ct for Roads &c.

For Daniel Brodhead Esq^r S.G.

Dr. James Hunter, D.S.

IN TESTIMONY that the above is a copy of the original remaining on file in the Department of Internal Affairs of Pennsylvania, made conformably to an Act of Assembly approved the 16th day of February, 1833, I have hereunto set my Hand and caused the Seal of said Department to be affixed at Harrisburg, this twenty-first day of June 1907

Henry Howard
Secretary of Internal Affairs.